

410-WS-1816-NWS

FOLD DOWN SHOWER SEATS

VERSABLE
DESIGNS

Construction

- 304-SS Frame
- Padded Naugahyde Wrap Top

Benefits

- ADA Compliant
- Supports 250lbs with proper installation
- Easily folds up out of the way when not in use
- No assembly required

Installation

- Use frame to mark holes
- Use 304-SS screws to secure into wood blocking
- Installation hardware included



18 x 16

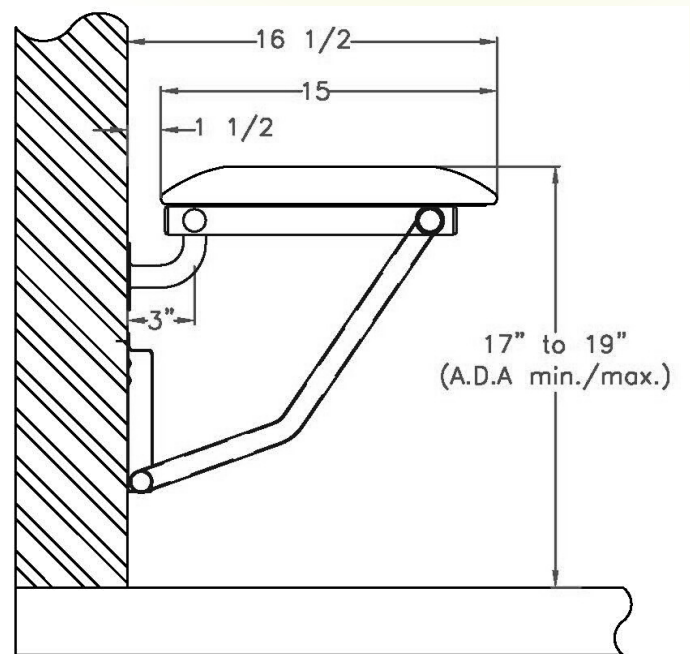
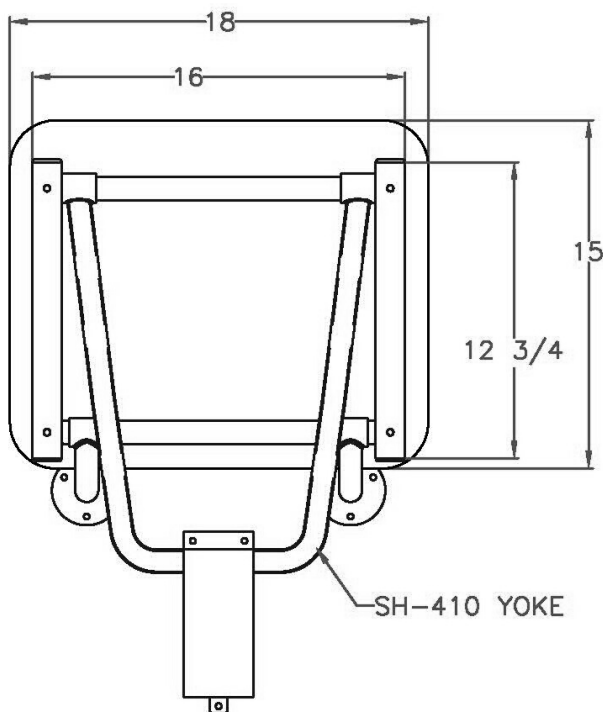

**ENABLING
INDEPENDENCE**

(877) 853-7816

sales@versabledesigns.com

WWW.VERSABLEDESIGNS.COM